



SOUTH PADRE ISLAND
4601 Padre Blvd.
South Padre Island, TX 78597
(956) 761-8106 * (956) 761-3888 fax

Contact:
Angelique "Nikki" Soto
NSoto@myspi.org
(956) 761-8106

PR 100 Median, Boardwalk and Sidewalk Improvement Project begins

South Padre Island, TX, Jan. 21, 2020: The City of South Padre Island is pleased to announce that the PR 100 Median, Boardwalk and Sidewalk Improvement Project has begun. The project started this month and is estimated to be completed within 15 months.

The project will continue to improve traffic and pedestrian mobility along Padre Boulevard 3.3 miles moving towards the Convention Centre.

The project will impact a total of 2.5 miles of lane closures in 11 phases. The first phase started on Dolphin Street, along Padre Boulevard, to Retama Street.

To minimize negative impacts to businesses during peak times, construction affecting any lane closure is scheduled to temporarily pause during:

- March (entire month)
- April (3 -12)
- June (Fridays - Sundays)
- July (entire month)
- August (Fridays - Sundays)
- Any City Recognized Holiday

The PR 100, Median, Boardwalk and Sidewalk Improvement Project is part of the Venue Tax Project approved by South Padre Island voters on November 8th, 2016 and funded through the Venue Tax Fund.

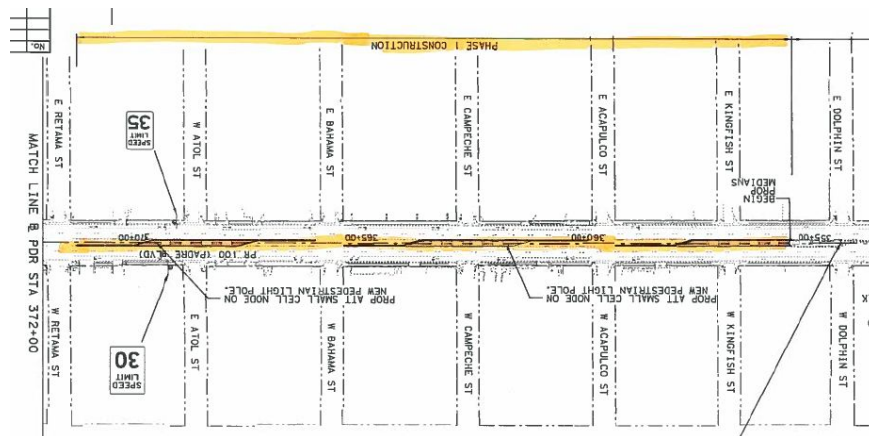

###