



ISLAND VIBES

the Official Newsletter for the City of South Padre Island



UPCOMING EVENTS

Saturday Recycling

Date: Every Saturday

Time: 8:00 a.m. to 11:00 a.m.

Where: 4501 Padre Blvd

[Click here](#) for event details.

SPI Birding, Nature, and Alligator Sanctuary: Coastal Nature Camp

Date: June 10th - 13th & 24th - 27th

Time: 9:00 a.m. - 1:00 p.m.

Where: 6801 Padre Boulevard

[Click here](#) for event details.

Que Padre Latin Dance Festival

Date: June 27th - 30th

Start: 12:00 p.m.

Where: Isla Grand Beach Resort

[Click here](#) for event details.

Fourth of July Fireworks

Date: July 4th

Time: 9:15 p.m.

Where: Entertainment District

[Click here](#) for event details.

5th Annual Ron Hoover Fishing Tournament

Date: July 11th - 12th

Registration: 5:00 p.m.

Where: SPI Convention Center

[Click here](#) for event details.

There's no shortage of events happening on South Padre Island [Click here](#) to join the fun and see what's happening.

UPCOMING MEETINGS

Monday • June 2nd

9:00 AM • Convention Center and Visitors Advisory Board

Wednesday • June 4th

11:00 AM • Board of Ethics
5:30 PM • City Council Regular Meeting

View upcoming meetings, live stream in session, & watch archived meetings [here](#).



Follow us! @CityofSPI



Yard and Landscape of the Month



105 E. Lantana



The Palms Cafe

Congratulations to 105 E. Lantana and The Palms Cafe for being May's yard and landscape of the month!

Contact Parks & Recreation Manager, Debbie Huffman, at Dhuffman@myspi.org, to submit your Yard of the Month or Landscape of the Month nominations. Houses and businesses can be submitted.

Hurricane preparedness resources

Be prepared during this hurricane season. Planning what to do in advance is an important part of being prepared. As a coastal community, we all play a part in protecting our residents, businesses, and Island. Scan or click the QR code to view all the different resources.

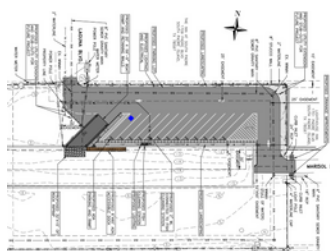

Marisol Proposed Boat Ramp

Want to share your thoughts on the proposed boat ramp and improvements at the west end of Marisol Street? Send them to kboburka@myspi.org! The EA is available for review on the City's website [here](#), and a physical copy will be available at 321 Padre

Boulevard, South Padre Island, Texas. The final day to submit a comment will be **Friday, 06 June 2025**. [Click here](#) to learn more about this project.

New Chamber Growth Fund!

The Chamber Growth Fund provides timely financial support to active Chamber members facing urgent, unforeseen disruptions to their businesses. [Click here](#) to read more!



Pet of the Week

Turbo is a puppy who's favorite thing to do is play with toys. He is believed to be a dachshund mix.

Meet all the animals at FOAR, on 4908 Padre Blvd., from 10:00 a.m.- 5:00 p.m. Complete the adoption application [here](#).

Short Term Rentals

Browse all the Short Term Rentals that are registered with the City of South Padre Island [here](#).

Summer Tips



Fill any holes made on the beach before leaving.

Use sunscreen and stay hydrated.



Shade devices can be set up on the beach between 9 AM-10 PM.

Glass is prohibited on the beach.



Mobichairs (beach wheelchairs) are available for free at the SPI Fire Station. Call SPIFD at (956) 761-3040 for more information.

Ride the Island Metro for free as many times as you need from 7:00 a.m. until 9:00 p.m. every day. View the bus schedule [here](#) and the route descriptions [here](#).



Be cautious of hot sand and pavement for yourself and your pets. If it's too hot for you it's too hot for them.

Do not allow your pets to drink salt water.

Bring your pet's vaccination records with you.

If you lose your pet they cannot be released without proof of a rabies vaccination.

If you lose your pet or find an animal needing assistance, call Friends of Animal Rescue 24/7 hotline at (956) 772-1171.



SPI PARKS



South Padre isn't just home to great food and a beautiful beach, there are also several parks to visit. To view more on our parks [click here!](#)



John L. Tompkins Park



Turtle Park



Queen Isabella Memorial Park



Pickleball Park



Water Tower Park

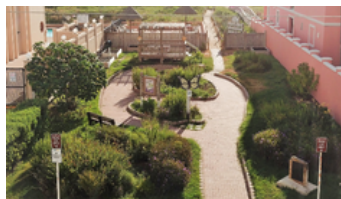

Butterfly Park



Lis Memorial Park.