



ISLAND VIBES

the Official Newsletter for the City of South Padre Island



UPCOMING EVENTS

Saturday Recycling

Date: Every Saturday
Time: 8:00 a.m. to 11:00 a.m.
Where: 4501 Padre Blvd
[Click here](#) for event details.

El Paseo Arts Foundation: Stephen Schwartz's Snapshots - A Musical Scrapbook

Date: May 8th - 10th
Starts: 7:30 p.m. - 9:30 p.m.
Where: SPI Convention Center
[Click here](#) for event details.

Shallow Sport

Date: May 9th - 10th
Registration: 4:30 p.m.
Where: SPI Convention Center
[Click here](#) for event details.

SPIBNAS: Alligator Sanctuary Anniversary Celebration

Date: May 10th
Starts: 11:00 a.m. - 4:00 p.m.
Where: 6801 Padre Boulevard
[Click here](#) for event details.

Run the Jailbreak

Date: May 17th - 18th
Registration: 7:30 a.m.
Where: Clayton's Beach Bar
[Click here](#) for event details.

There's no shortage of events happening on South Padre Island [Click here](#) to join the fun and see what's happening.

UPCOMING MEETINGS

Tuesday • May 13th

3:00 PM • Shoreline Task Force

Thursday • May 15th

3:00 PM • Planning & Zoning Commission

View upcoming meetings, live stream in session, & watch archived meetings [here](#).



Follow us! @CityofSPI



COUNCIL HIGHLIGHTS

Here are some highlights from the May 7th City Council Regular Meeting!

- Approval in the amount of \$15,510 for the roofing and structure repair at the Turtle Park Pavilion.
- Approval in the amount of \$600,000 for the Coastal Erosion Planning and Response Act Cycle 13 dune restoration grant.
- Presentation by the Visit SPI Spring Break recap and summer 2025 Marketing Plan.



To watch this meeting online click or scan the QR code.



National Police Week

National Police Week recognizes the sacrifices made by our law enforcement officers and their families, and honors those who have paid the ultimate price in the line of duty. These brave men and women often

place themselves in harm's way to uphold the law, preserve peace, and safeguard our lives and property. Thank you, Officers, for your continuous dedication to serving and protecting our community.

Last Day to Protest Your Appraised Value

If you believe that the APPRAISED VALUE is incorrect or that there is an error on your account, you may file a protest. [Click here to read more.](#)

Protests must be received or postmarked on or before May 15th or 30 days after the date on the Appraisal Notice, whichever is later.



CUPID

Pet of the Week

Cupid is the life of the party at Friends of Animal Rescue. He is carefree, social with dogs and humans, and life of the party. Great for an active home.

Meet all the animals at FOAR, on 4908 Padre Blvd., from 10:00 a.m.- 5:00 p.m. Complete the adoption application [here](#).

Celebrate in Paradise

The SPI Community Center provides an excellent facility for a variety of activities to serve and support residents and organizations. For more info, call (956) 761-8168 or email communitycenter@myspi.org.



Marisol Street Proposed Boat Ramp 30-Day Public Comment Period

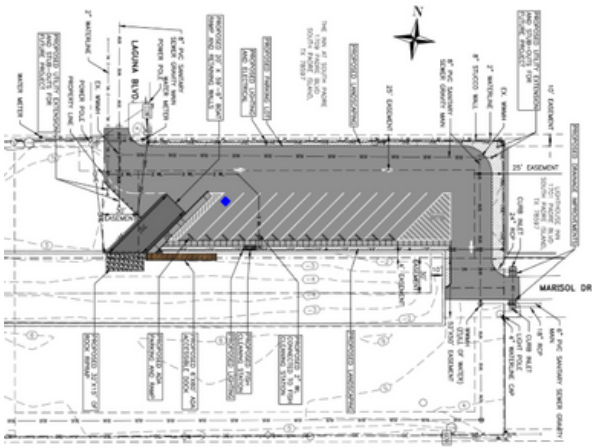

The City of South Padre Island has prepared an environmental assessment (EA) regarding the proposed construction of a public boat ramp and associated improvements at the western terminus of Marisol Street on South Padre Island, Texas. The EA assesses the potential environmental impacts of the proposed project, which includes the creation of a boat ramp with scour protection and an ADA accessible loading dock/attendant dock.

This notice is intended to make the public aware of the 30-day public comment period, which will **commence on**

Thursday, 08 May 2025, with comments due by the end of the day on Friday, 06 June 2025, to kboburka@myspi.org. The EA is available for review on the City of South Padre Island's website [here](#) and at 321 Padre Boulevard, South Padre Island, Texas, where a physical copy can be reviewed.

Become a Part of the SPI Guide

Want your business to shine? Join the South Padre Island Chamber of Commerce SPI Guide! With over 75,000 copies made your business will be advertised in hotels, information centers, travel agencies, big events, and more!

For more information, contact Dianna L. Haravill, Marketing Director for the Chamber of Commerce, by calling (956) 761-4412 or emailing dianna@spichamber.com.

You can also request to have guides sent to you! [Click here](#) to get your SPI Guide. [Sign-up](#) to stay "In the Know" by subscribing to the Chamber of Commerce's weekly newsletter.



SPI Parks!

South Padre isn't just home to great food and a beautiful beach, there are also several parks to visit. To view more on our parks [click here!](#)

Butterfly Park ● John L. Tompkins Park ● Lis Memorial Park
Water Tower Park ● Turtle Park ● Pickleball Park
Queen Isabella Memorial Park

#Join Team SPI

The City of SPI is hiring! [Apply](#) to become a part of our team today! The City offers great benefits like medical, retirement, and more!

Visit South Padre Island's New Look

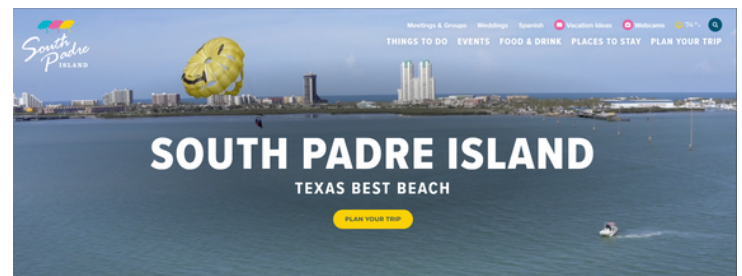

Discover what the best beach in Texas has to offer on the new [VisitSouthPadreIsland.com](https://www.VisitSouthPadreIsland.com) website. From vacation ideas to updates on upcoming events, this will be your one-stop shop for your new favorite destination.

National Tourism Week



South Padre Island is blessed with a beautiful beach, a pristine Laguna Madre Bay, and the dedication of countless residents, who promote our rich tradition of hospitality. Over the years, this has blossomed into a multimillion-dollar travel and tourism industry.

National Tourism Week recognizes those who are dedicated to helping visitors and citizens discover everything South Padre Island has to offer.